

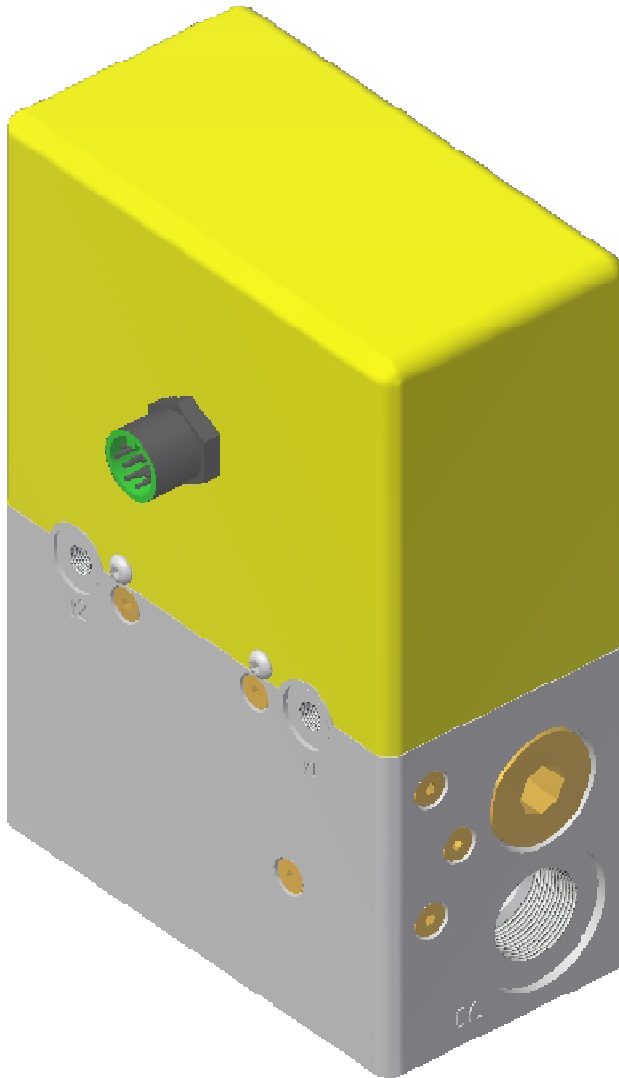

# RMBV-17-16-24VDC Redundantly Monitored Blocking Valve



## Function

This 2-way, 2 position hydraulic valve package features redundant valve elements that allow series flow from the inlet to the outlet. This configuration assures that if any valving element fails to operate as requested, flow will be blocked. The shifting of each valving element is monitored by its own sensor.

## Typical Applications

Bending Machines  
Trimming Machines  
Cutting, Forming, Piercing Machines

**Ports:** Inlet(1) = SAE #16  
Outlet(2) = SAE #16  
Tank(3) = SAE #16

**Solenoid Volage:** 24 VDC / 38 watts total

**Nominal Flow Rate:** 60 GPM

# Dimensional Information

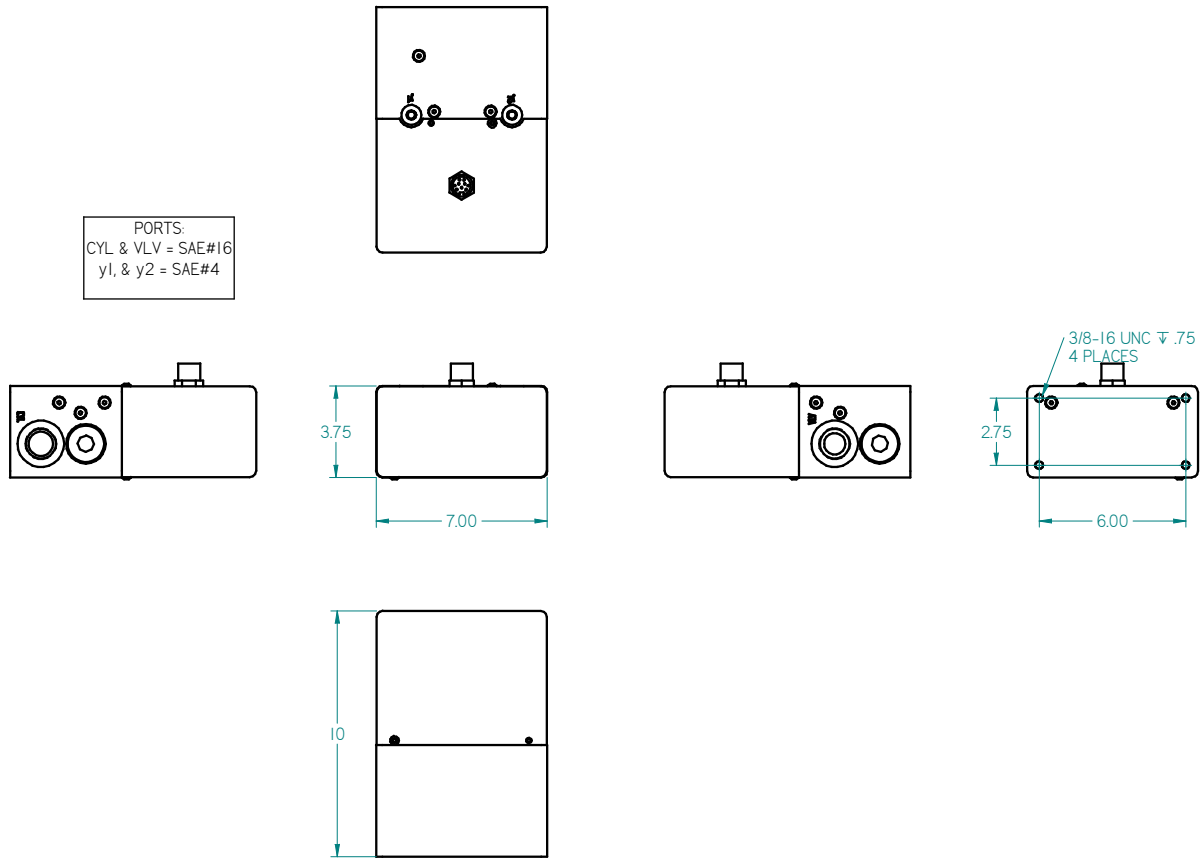

# Wiring Diagram

ALLEN-BRADLEY  
888M-M12AE-DF5  
RECEPTACLE

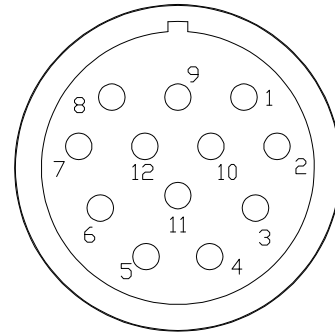
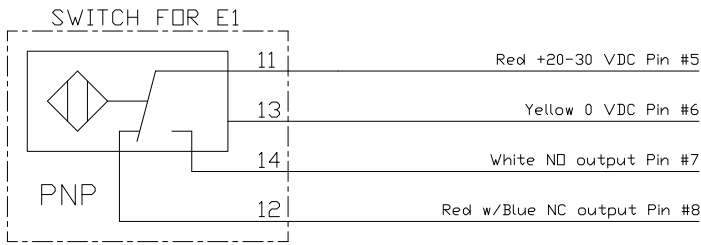

PILOT VALVES  
P1 & P2

